

**01 General Notes**  
SCALE: 1/4" = 1'-0"

**02 General Notes**  
SCALE: 1/4" = 1'-0"

**03 Tenant Floor Plan**  
SCALE: 1/4" = 1'-0"

**01 General Notes**  
SCALE: 1/4" = 1'-0"

ALL DIMENSIONS ARE TO FACE OF FINISH, UNLESS OTHERWISE NOTED.  
 1. KITCHEN BASE CABINETS ARE TO BE 30" HIGH AND 22" DEEP.  
 2. KITCHEN BASE DRAWERS ARE TO BE 12" HIGH AND 22" DEEP.  
 3. KITCHEN ISLAND CABINETS ARE TO BE 36" HIGH AND 24" DEEP.  
 4. KITCHEN ISLAND DRAWERS ARE TO BE 12" HIGH AND 24" DEEP.  
 5. PROVIDE SLEEF SUPPORTS 4" ON CENTER HORIZONTAL.  
 6. PROVIDE SLEEF SUPPORTS 4" ON CENTER HORIZONTAL.  
 7. ALL SHELVES TO BE 18" HIGH UNLESS OTHERWISE NOTED.  
 8. WATER RESISTANT GYP. IS REQUIRED. EXTEND TYPE "X" DRYWALL TO FLOOR LEVEL BEHIND TUBS AT INTERIOR DOORS AND AT FLOOR STUD FACE TO HINGE SIDE OF DOOR OR INTERIOR DOORS ARE CENTERED WITH IN OPENING UNLESS OTHERWISE NOTED.

**architettura**  
architettura inc.  
940 simon  
plano, texas 75025  
t. 972.517.9172 f. 972.527.3217  
pollacia@cmpu.net

**STATE OF NEW MEXICO**  
FRANK POLLACIA  
NO. 2397  
REGISTERED ARCHITECT

Project No. 70701  
Date: 7 Aug 1998  
Issue for Permit  
City Comments

# Santa Fe Computer Works

Camino Carlos Rey & Cerrillos Road  
Santa Fe, New Mexico

Sheet Title:  
Tenant Floor Plan  
Drawing No.  
**A3.01**



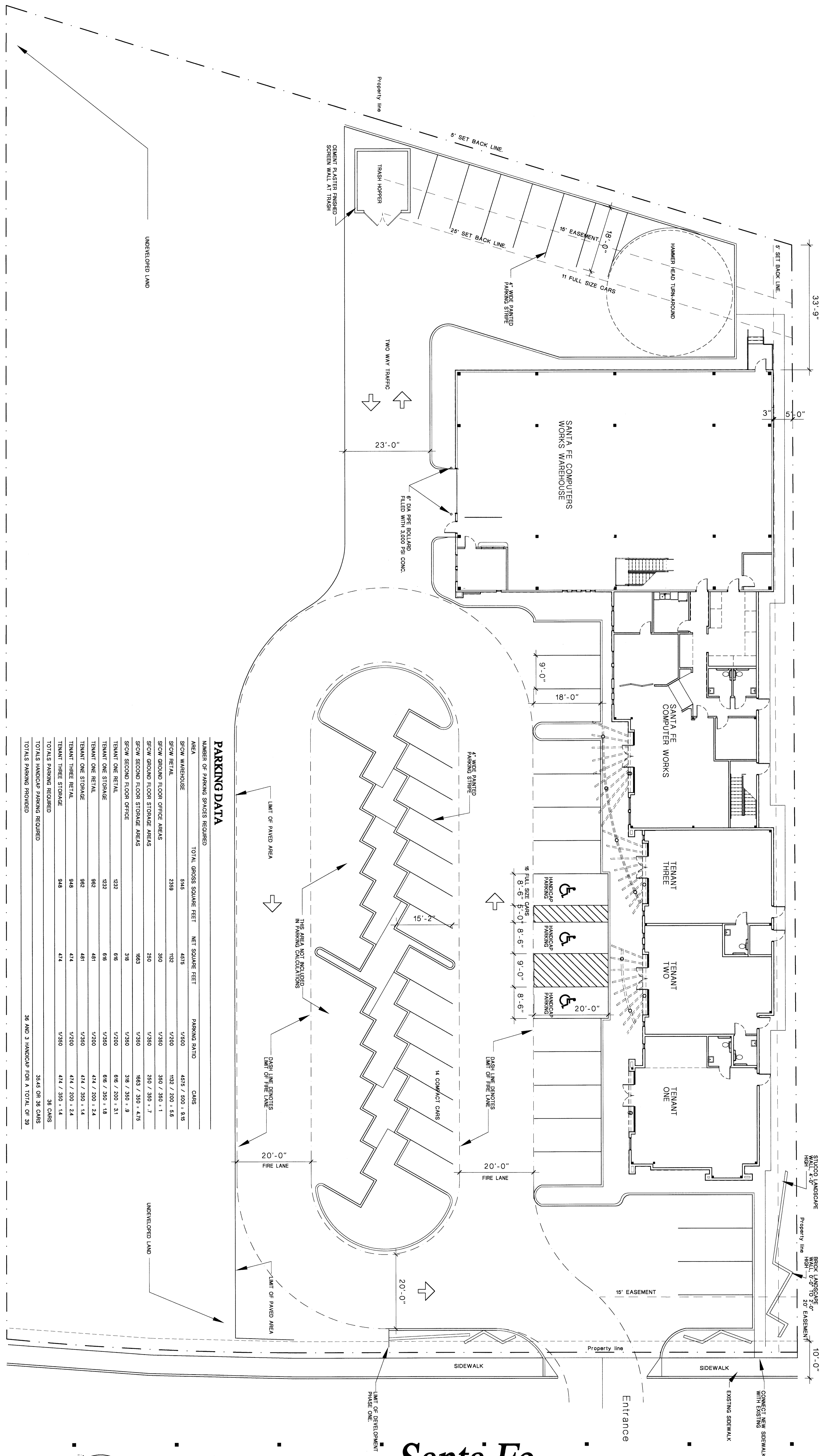

**PARKING DATA**

NUMBER OF PARKING SPACES REQUIRED

AREA	TOTAL GROSS SQUARE FEET	NET SQUARE FEET	PARKING RATIO	CARS
SFCW WAREHOUSE	5146	4575	1/500	4575 / 500 = 9.15
SFCW RETAIL	2389	1032	1/250	1032 / 250 = 4.13
SFCW GROUND FLOOR OFFICE AREAS	360	360	1/250	360 / 250 = 1.44
SFCW GROUND FLOOR STORAGE AREAS	260	260	1/250	260 / 250 = 1.04
SFCW SECOND FLOOR STORAGE AREAS	1683	1683	1/250	1683 / 250 = 6.73
SFCW SECOND FLOOR OFFICE	38	38	1/250	38 / 250 = .15
TENANT ONE RETAIL	608	608	1/250	608 / 250 = 2.43
TENANT ONE STORAGE	481	481	1/250	481 / 250 = 1.92
TENANT ONE OFFICE	481	481	1/250	481 / 250 = 1.92
TENANT THREE RETAIL	474	474	1/250	474 / 250 = 1.89
TENANT THREE STORAGE	474	474	1/250	474 / 250 = 1.89
TOTALS HANDICAP PARKING REQUIRED				36 HANDICAP FOR A TOTAL OF 39
TOTALS HANDICAP PARKING PROVIDED				36 AND 3 HANDICAP FOR A TOTAL OF 39

**Santa Fe Computer Works**

Camino Carlos Rey & Cerrillos Road  
Santa Fe, New Mexico

architettura  
architettura inc.  
940 simon  
plano, texas 75025  
t. 972.517.9172 f. 972.527.3217  
pollacia@cmpu.net

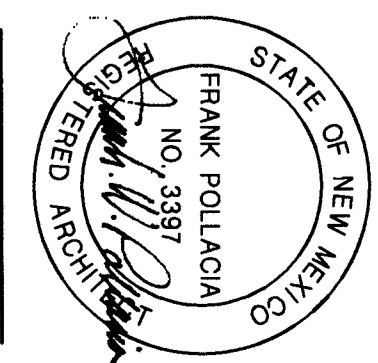

Project No. 70701  
Date 7 Aug 1998  
Issue for Permit  
City Comments 9 Dec 98

01 Site Plan  
SCALE: 3/16" = 1'-0"

Sheet Title: Site Plan  
Drawing No. A0.02