

# For Lease



*1421 Luisa Street, Suite J*

**Offered at \$1282.00 /Monthly**

- ❖ Four Large Offices, windows in every office.
- ❖ Reception/Waiting area
- ❖ Break area with sink
- ❖ Storage Closet
- ❖ Handicap Bathroom
- ❖ Square footage: 899
- ❖ Carpeting throughout
- ❖ Mix Use Area
- ❖ 1<sup>st</sup> Month rent and equal security deposit required
- ❖ Minimum 12 months lease
- ❖ Zoned: C-1

## **COMMERCIAL PROPERTIES INC**

2019 Galisteo St. Ste L-1  
Santa Fe, NM 87505  
505-988-8081

### **BROKER**

**George Jimenez**

**215-1501**





# 1421 Luisa St #J

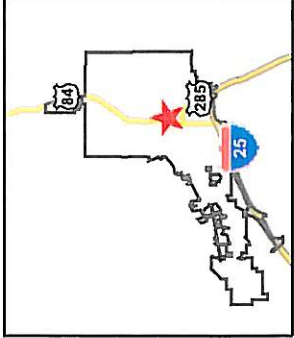

### Legend

- City Limits
- Address Points
- Parcels
- Santa Fe River
- Zoning
  - RR Rural Residential
  - R1, (PUD) Single - Family 1du/ac
  - R2, (DT), (PUD) Single - Family 2du/ac
  - R3, (PUD) Single - Family 3du/ac
  - R4 Single - Family 4du/ac
  - R5, (DT), (PUD), (AC), R6 Single - Family 5-6du/ac
  - R7, (I), (PUD), R8 Single - Family 7-8du/ac
  - RCS, ACRC5 Compound 5du/ac
  - RC8, ACRC8 Compound 8du/ac
  - RM10, (PUD) Multiple - Family 10du/ac
  - RMLD, (PUD) Multiple - Family 12du/ac
  - RM1, (PUD) Multiple - Family 21du/ac
  - RM2, (PUD) Multiple - Family 25du/ac
  - RAC Residential Arts & Crafts
  - MHP Mobile Home Park

Scale: 1:1,923

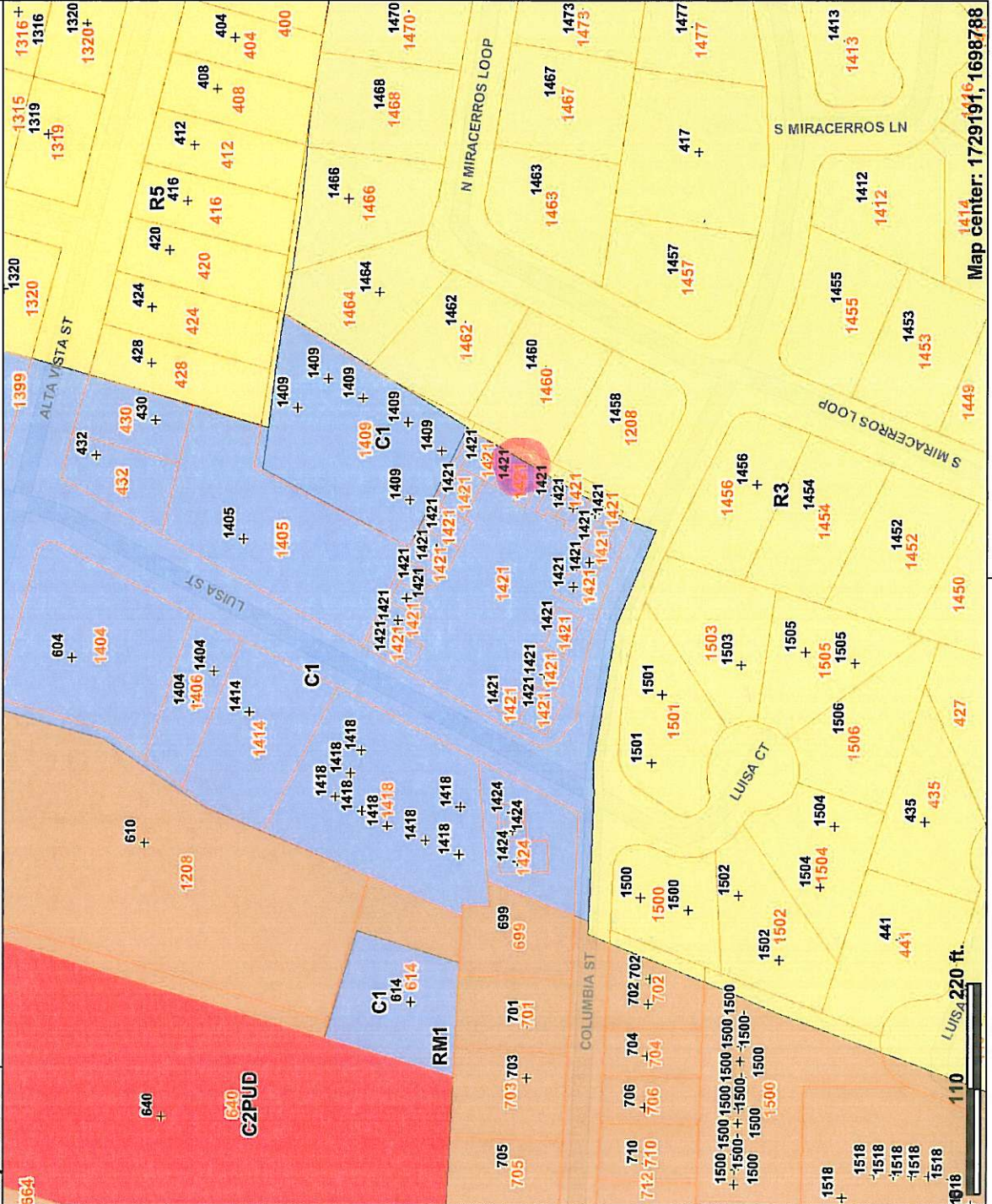

This map is a user generated static output from an Internet mapping site and is for general reference only. Data layers that appear on this map may or may not be accurate, current, or otherwise reliable. THIS MAP IS NOT TO BE USED FOR NAVIGATION.